

# BLUEY



## Instruction Manual

# BLUEY'S BOOK OF GAMES



**BBC**  
**STUDIOS**

BLUEY (word mark and character logos) are trade marks of Ludo Studio Pty Limited and are used under licence. BLUEY logo © Ludo Studio Pty Limited 2018. Licensed by BBC Studios. BBC is a trade mark of the British Broadcasting Corporation and is used under licence. BBC logo © BBC 1996

**VTech** understands that a child's needs and abilities change as they grow and with that in mind we develop our toys to teach and entertain at just the right level...

## **vtech** Baby

**Toys that will stimulate their interest in different textures, sounds and colours**

### I am...

...responding to colours, sounds and textures

...understanding cause and effect

...learning to touch, reach, grasp, sit-up, crawl and toddle

Birth-36 months



## **Pre-School**

**Interactive toys to develop their imagination and encourage language development**

### I want...

...to get ready for school by starting to learn the alphabet and counting

...my learning to be as fun, easy and exciting as can be

...to show my creativity with drawing and music so my whole brain develops

3-6 years



## **Electronic Learning Computers**

**Cool, aspirational and inspiring computers for curriculum related learning**

### I need...

...challenging activities that can keep pace with my growing mind

...intelligent technology that adapts to my level of learning

...National Curriculum based content to support what I'm learning at school

4-10 years



To learn more about this and other VTech® products, visit [www.vtech.co.uk](http://www.vtech.co.uk)

# INTRODUCTION

Thank you for purchasing **Bluey's Book of Games!** Turn the pages and play with Bluey and Bingo for real life! Discover the games Bluey has imagined and find items around your house to play along.



① Light-Up Buttons

② Bluey Button

③ Story Mode Button

④ On/Off Button

⑤ Volume Button

⑥ Bandit Button

⑦ Play Together Mode Button

⑧ Chilli Button

⑨ Music Mode Button

⑩ Bingo Button

⑪ Follow Me Mode Button

⑫ Book Pages

# INCLUDED IN THE PACKAGE

- Bluey's Book of Games
- Quick Start Guide

## WARNING

All packing materials such as tape, plastic sheets, packaging locks, removable tags, cable ties, cords and packaging screws are not part of this toy and should be discarded for your child's safety.

## NOTE

Please save this Instruction Manual as it contains important information.

## Unlock the Packaging Locks

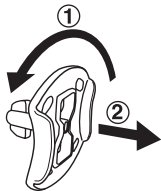

- ① Rotate the packaging locks 90 degrees anti-clockwise.
- ② Pull out the packaging locks and discard.

# INSTRUCTIONS

## Battery Removal and Installation

1. Make sure the unit is turned **Off**.
2. Find the battery cover located on the back of the unit, use a screwdriver to loosen the screw and then open the battery cover.
3. Remove old batteries by pulling up on one end of each battery.
4. Install 3 new AA (LR6/AM-3) batteries following the diagram inside the battery box. (For best performance, alkaline batteries or fully charged Ni-MH rechargeable batteries are recommended.).

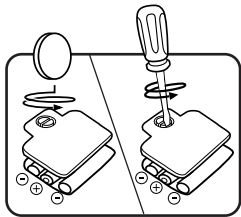

5. Replace the battery cover and tighten the screw to secure.

**WARNING:**

Adult assembly required for battery installation.  
Keep batteries out of reach of children.

**IMPORTANT: BATTERY INFORMATION**

- Insert batteries with the correct polarity (+ and -).
- Do not mix old and new batteries.
- Do not mix alkaline, standard (carbon-zinc) or rechargeable batteries.
- Only batteries of the same or equivalent type as recommended are to be used.
- Do not short-circuit the supply terminals.
- Remove batteries during long periods of non-use.
- Remove exhausted batteries from the toy.
- Dispose of batteries safely. Do not dispose of batteries in fire.

**RECHARGEABLE BATTERIES:**

- Remove rechargeable batteries from the toy before charging.
- Rechargeable batteries are only to be charged under adult supervision.
- Do not charge non-rechargeable batteries.

**Disposal of batteries and product**



The crossed-out wheellie bin symbols on products and batteries, or on their respective packaging, indicates they must not be disposed of in domestic waste as they contain substances that can be damaging to the environment and human health.



The chemical symbols Hg, Cd or Pb, where marked, indicate that the battery contains more than the specified value of mercury (Hg), cadmium (Cd) or lead (Pb) set out in the Batteries and Accumulators Regulation.

The solid bar indicates that the product was placed on the market after 13th August, 2005.

Help protect the environment by disposing of your product or batteries responsibly.

VTech® cares for the planet.

Care for the environment and give your toy a second life by disposing of it at a small electricals collection point so all its materials can be recycled.

In the UK:

Visit [www.recyclenow.com](http://www.recyclenow.com) to see a list of collection points near you.

In Australia & New Zealand:

Check with your local council for kerbside collections.

## PRODUCT FEATURES

### 1. On/Off Button

Press the **On/Off Button** to turn the unit On. To turn the unit Off, press the **On/Off Button** again.

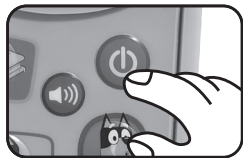

### 2. Volume Button

Press **Volume Button** to adjust the volume level.

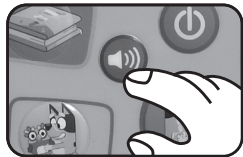

### 3. Story Mode Button

Press the **Story Mode Button** to learn about Bluey's favourite pretend-play games with a short story.



### 4. Play Together Mode Button

Press the **Play Together Mode Button** to hear about the rules and items needed to play Bluey's silly invented games.



### 5. Music Mode Button

Press the **Music Mode Button** to add sound effects to the melodies by pressing the colourful buttons.



### 6. Follow Me Mode Button

Press the **Follow Me Mode Button** to remember a list of items Bluey needs and get them in the correct order.

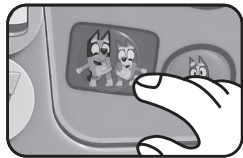

### 7. Character Buttons

Press the **Bluey, Bandit, Chilli and Bingo Buttons** to hear Bluey and Bingo introduce themselves or family members.

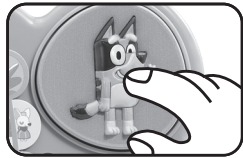

## 8. Four Light-Up Buttons

Press the colourful **Light-Up Buttons** to play games and hear phrases from Bluey and Bingo. The lights flash with the sounds and music.



## 9. 14 Book Pages

Turn to any page to hear and play different role-playing stories, melodies and games.

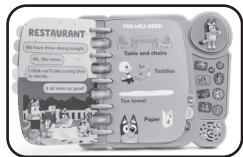

## 10. Automatic Shut-Off

To preserve battery life, the unit will automatically turn off after several minutes of inactivity. The unit can be turned on again by pressing the **On/Off Button**. If the unit repeatedly turns itself off or displays abnormal responses, please insert new batteries and try again.

## CARE & MAINTENANCE

1. Keep the unit clean by wiping it with a slightly damp cloth.
2. Keep the unit out of direct sunlight and away from any direct heat sources.
3. Remove the batteries if the unit will not be in use for an extended period of time.
4. Do not drop the unit on hard surfaces and do not expose the unit to moisture or water.



# TROUBLESHOOTING

If for some reason the program/activity stops working or malfunctions, please follow these steps:

1. Please turn the unit **Off**.
2. Interrupt the power supply by removing the batteries.
3. Let the unit stand for a few minutes, then replace the batteries.
4. Turn the unit **On**. The unit should now be ready to use again.
5. If the unit still does not work, install a new set of batteries.

# CONSUMER SERVICES

Creating and developing **VTech®** products is accompanied by a responsibility that we at **VTech®** take very seriously. We make every effort to ensure the accuracy of the information, which forms the value of our products. However, errors sometimes can occur. It is important for you to know that we stand behind our products and encourage you to call our Consumer Services Department with any problems and/or suggestions that you might have. A service representative will be happy to help you.

## **UK Customers:**

Phone: 0330 678 0149 (from UK) or +44 330 678 0149 (outside UK)

Website: [www.vtech.co.uk/support](http://www.vtech.co.uk/support)

## **Australian Customers:**

Phone: 1800 862 155

Website: [support.vtech.com.au](http://support.vtech.com.au)

## **NZ Customers:**

Phone: 0800 400 785

Website: [support.vtech.com.au](http://support.vtech.com.au)

# PRODUCT WARRANTY/ CONSUMER GUARANTEES

## **UK Customers:**

Read our complete warranty policy online at [vtech.co.uk/warranty](http://vtech.co.uk/warranty).

## **Australian Customers:**

VTECH ELECTRONICS (AUSTRALIA) PTY LIMITED – CONSUMER GUARANTEES

Under the Australian Consumer Law, a number of consumer guarantees apply to goods and services supplied by VTech Electronics (Australia) Pty Limited. Please refer to [vtech.com.au/consumerguarantees](http://vtech.com.au/consumerguarantees) for further information.

**Visit our website for more  
information about our products,  
downloads, resources and more.**

***www.vtech.co.uk***  
***www.vtech.com.au***



TM & © 2022 VTech Holdings Limited.  
All rights reserved.  
IM-541200-001  
Version:0